

PEMC Series

DC Molded Case Circuit Breaker



PEMC Series

DC Molded Case Circuit Breaker



PROJOY
electric

– Switch To Safety! –

Features

PEMC DC Molded Case Circuit Breaker is suitable for large-scale PV systems, energy storage system, DC rated voltage can achieve 500 -1000V. Used in the rated current under 250A and distribution circuit, PEMC can be used as overload and short circuit protection, or as infrequent operation conversion of lines under normal conditions, which can quickly disconnect the fault current of DC system and ensure the stable operation of inverter, junction box and battery pack.

- Short circuit protection and overload protection can be operated with load, with superior performance;
- Non-polar, easy to install;
- Rated working current up to 250A;
- Rated working voltage up to 1000V;
- Compact design and compact structure;
- Zero flying arc (no external arc extinguishing cover is required).



Select Code

PEMCseries

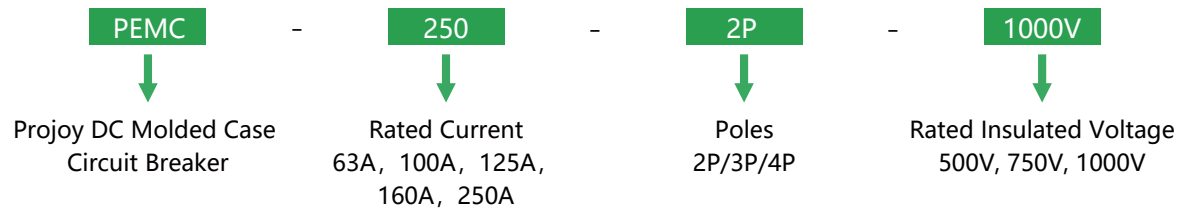

Contact Configuration

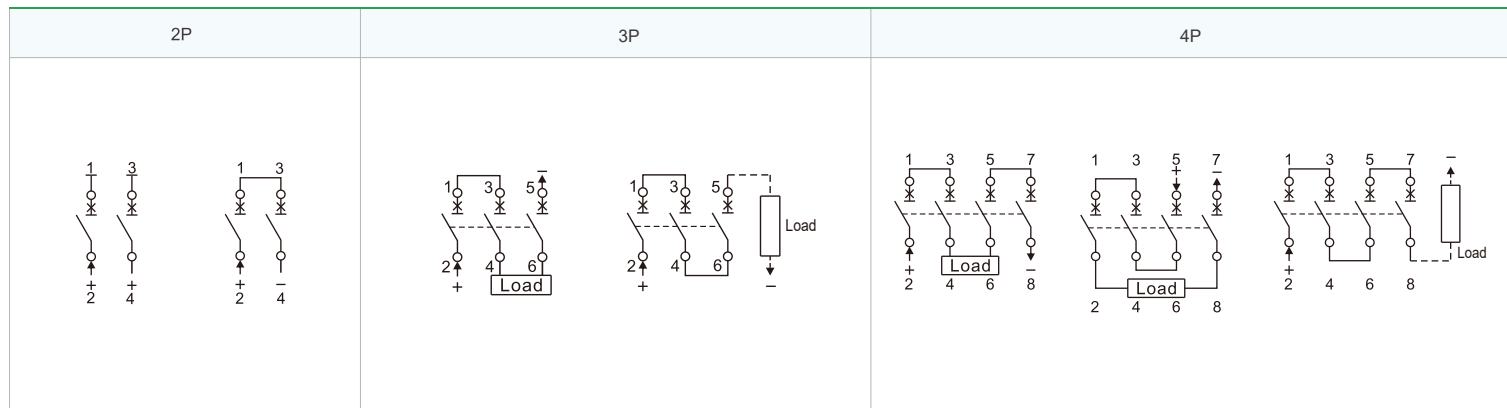

Technical data

Type		PEMC		
Shell frame grade rated current I_{mn} (A)		250		
Poles		2P	3P	4P
Rated Current I_n (A)		63, 100, 125, 160, 250		
Rated Insulated Voltage (V)		1000		
Rated Impulsed Voltage U_{imp} (KV)		8		
Rated Working Voltage U_e (V)		DC500	DC750	DC1000
Rated limit short circuit breaking capacity (KA)	DC1000V	40	40	40
Rated operating short circuit breaking capacity (KA)	DC1000V	20	20	20
Mechanical Life		10000		
Electrical Life		1000		
Size (mm)	L	165	167	167
	W	70	142	177
	H	103	106	106

Dimensions

2P

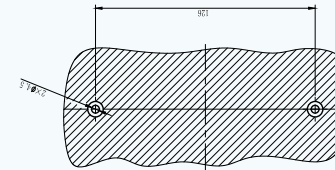
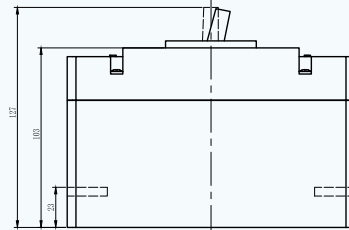
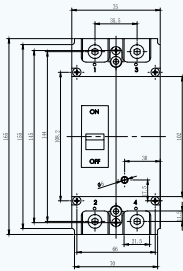

3P

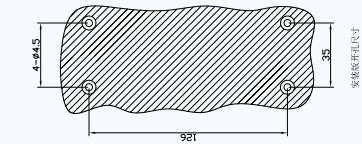
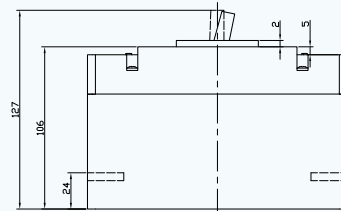
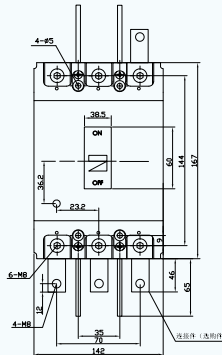

4P

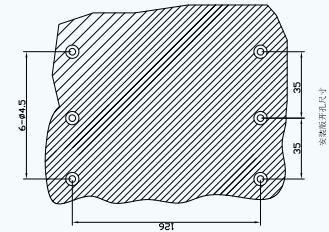
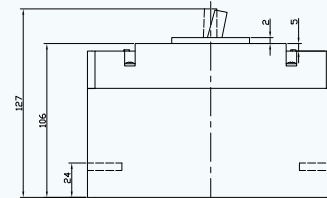
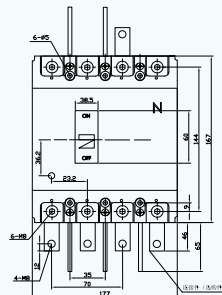



PROJOY
electric
— *Switch To Safety!* —

ProJoy Electric Co., Ltd.

58 Qinglonggang Road, Tiancheng Times Business Plaza 30F, Suzhou, Jiangsu

Tel: +86 512 6878 6489 | Fax: +86 512 6878 6489

Email: sales@projoy-electric.com | www.projoy-electric.com